

Fire Rated Wall Box **WBR-FR1** Installation Instructions

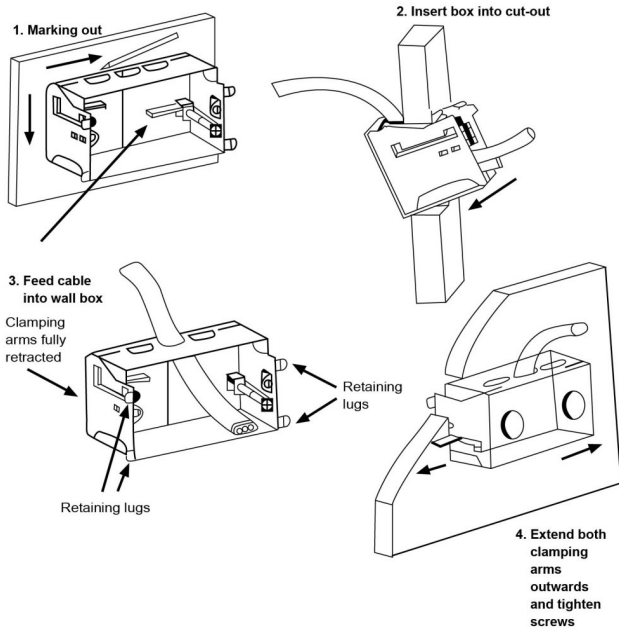

Acoustic Rated Up To STC50 - Fire Rated For One and Two Hours*

1. Use box as a template to mark the cut out (52mm x 98mm)
2. Cut an opening in wall with care to ensure a neat fit of the box.
3. Remove knockout for cable entry. If bringing cables through the rear of the box, slit intrumescent material carefully with a sharp knife but do not remove any material.
4. Feed cables into wall box.
5. Ensure clamping arms are fully retracted into the box.
6. Insert box into wall cut out. Single gang only: fold down flap, insert box and restore flap after insertion.
7. Extend clamping screws until box is firmly fixed in position. **DO NOT OVERTIGHTEN.**
8. Gently tap retaining lugs until flush with wall face.
9. To ensure acoustic rating, gasket is supplied.

*Rating is dependent on strict adherence to installation instructions.

Use Fyre-Seal Mastic to seal any gaps around box or to replace any intrumescent material inadvertently removed.